

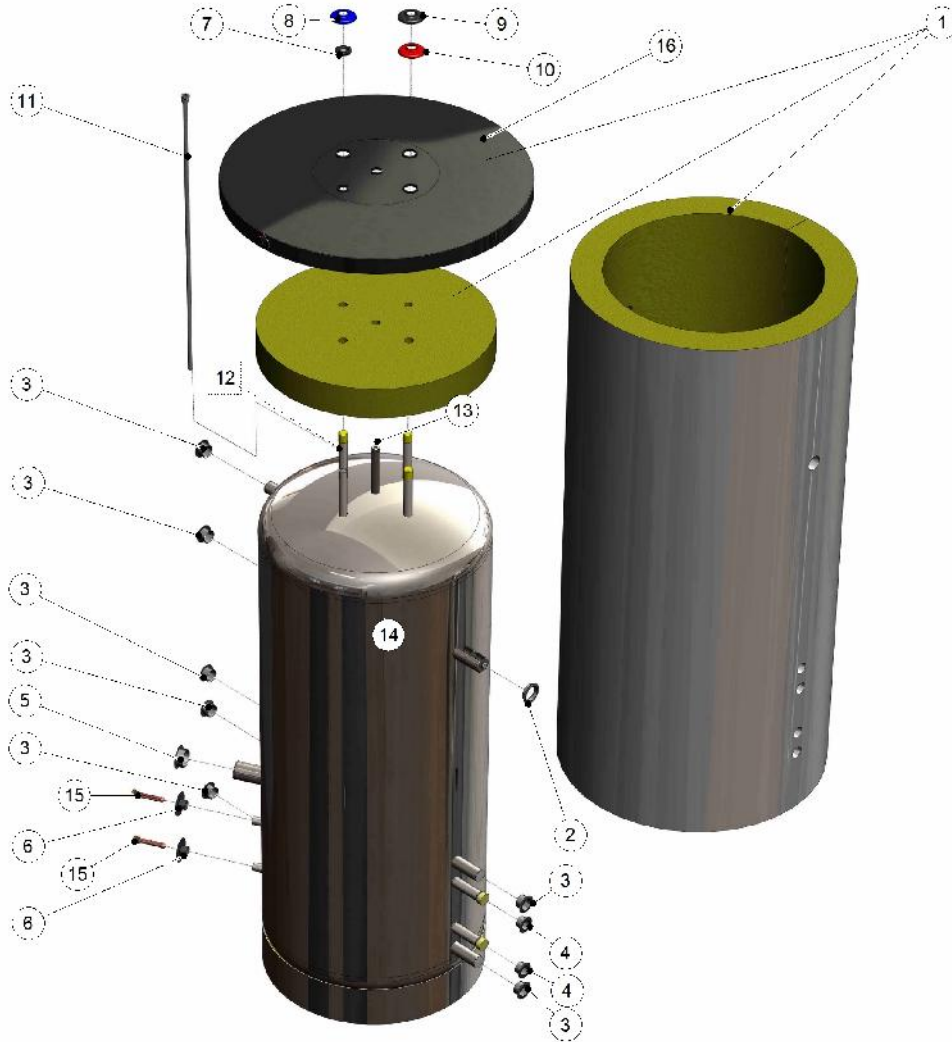









Smart ME 600 soft casing

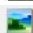

	Code	Quant.	Photo	Description	De --- A ---	Remarque
1	60772142	1		Kit Emballage SLME 600		
2	49410201	1		Bague de retenue manchon 5/4		
3	49410069	7		Bague de retenue manchon 4/4		
4	497B1039	2		Bague de fixation 3/4		
5	497B1026	1		Bague de fixation 6/4		
6	49410248	2		Bague reten Manch 1/2 (25,8) noir PVC		
7	557A0060	1		Joint soufflet d:21 Dp:40		
8	497B1048	1		Bague de retenue 3/4 bleue		
9	497B1050	1		Bague de retenue 3/4 noire		
10	497B1049	1		Bague de retenue 3/4 rouge		
11	39438046	1		Doigt de gant inox 1/2x950		
12	497B0008	1		Plonge PVCc 19,5x1140 perç.lat.		
13	55445006	1		Purgeur air man.1/2		

14	27300548	1		Corps emballé Smart ME 600		
15	63438001	2		Doigt de gant laiton 1/2x100 3 bulbes		
16	A1002619	1		Calotte sup. SLME600 soft jacket		